

TETON CITY ORDINANCE NO.304
FREMONT COUNTY ORDINANCE NO. 2005-05

AN ORDINANCE ESTABLISHING AN AREA OF CITY IMPACT INTE THE UNINCORPORATED PORTION OF FREMONT COUNTY AND MADISION COUNTIES SURROUNDING THE CITY OF TETION, IDAHO, ADOPTING AN OFFICAL MAP OF THAT AREA AND ESTABLISHING ZOING IN THE AREA OF THE CITY IMPACT.

BE IT HEREBY ORDAINED BY THE GOVERNING BOARDS OF THE CITY OF TETON AND THE COUNTY OF FREMONT, as follows:

1. Teton Area of City Impact. The area of city impact for the City of Teton is established within the boundaries and illustrated on the map, attached hereto as Exhibit A, which map is hereby made a part of this ordinance.

2. Zoning of Area of City Impact. The zoning of area established with the area of impact is established as agriculture (Zone A), highway commercial (Zone HC), and residential (Zone RA) as indicated on the map attached hereto as Exhibit A.

3. Effective Date. This ordinance shall be in full force and effect, from and after its passage, all as provided by law.

PASSED AND APPROVED BY THE MAYOR AND COUNCIL OF THE CITY OF TETON THIS 28TH DAY OF October, 2005.

PASSED AND APPROVED BY THE BOARD OF COUNTY COMMISSIONERS OF FREMONT COUNTY THIS 28th DAY OF February, 2005.

BOARD OF COUNTY COMMISSIONERS
FREMONT COUNTY, IDAHO

Donald D. Trapp
CHAIRMAN

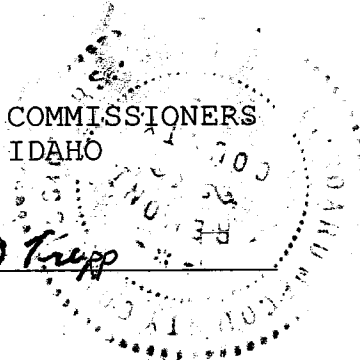

ATTEST:

Abbie Mace
ABBIE MACE, COUNTY CLERK

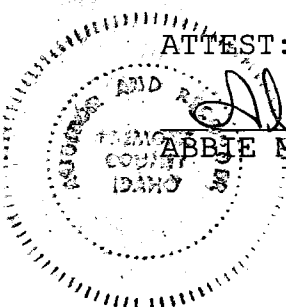

CITY OF TETON, IDAHO

BRYAN PARKER, MAYOR

493949

ATTEST:

JOLYN BRIGGS, CITY CLERK

493949

Teton of Teton Proposed Zoning with in the Impact Area

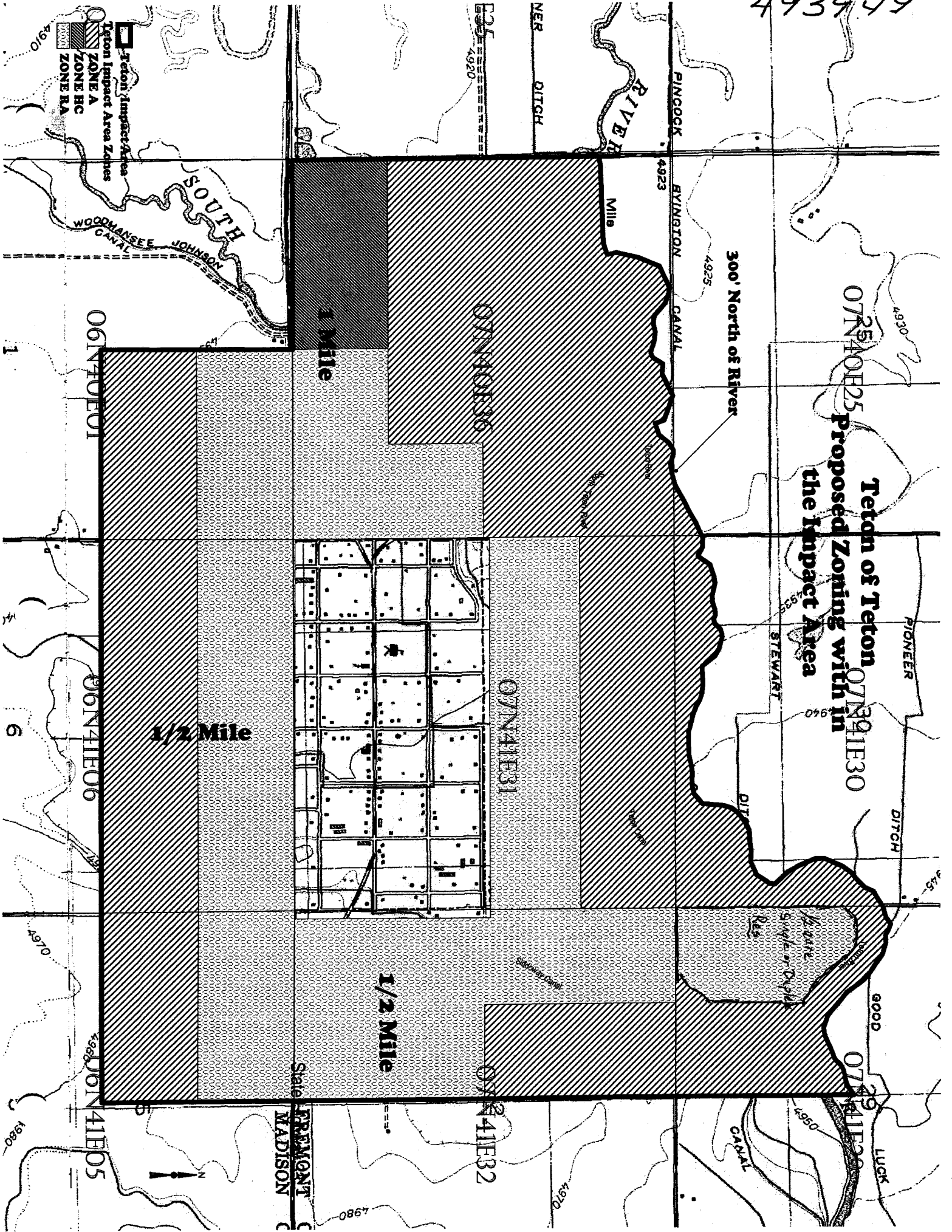

Teton Impact Area
Zones

- Zone A
- Zone HC
- Zone RA

06N41E01

06N41E06

06N41E05

1 Mile

1/2 Mile

1/2 Mile

07N41E30

07N41E31

07N41E32

300' North of River

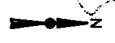

State
FREMONT
MADISON

BYINGTON CANAL

STEWART

DITCH

DITCH

GOOD

LUCK

Mills

Boone
Sample
Cayle

4910

4920

4923

4925

4930

496

4970

4980

4980

4970

4950

1980

1

6

545